



100 Leetsdale Industrial Drive, Suite B
Leetsdale, PA 15056

Non-Profit
U.S. Postage
PAID
Sewickley, PA
Permit No. 19



September 2023



HS UPDATE AND PANEL DISCUSSION:

- September 20, 2023 at 6:00 p.m.
Quaker Valley High School Auditorium

PROPERTY TOURS:

- September 14, 2023 at 1:00 p.m. and 6:00 p.m.
- October 5, 2023 at 6:00 p.m.

Stay tuned for registration information!

Learn more at www.qvsd.org/BlueprintQV

Dear Quaker Valley School District Community,

Welcome to the 2023–2024 school year! As we begin the new year, we cannot help but feel excited about the opportunities and possibilities that lie ahead. New beginnings and the first weeks of school are always filled with anticipation, and we are thrilled to share this journey together with all of you.

As we embark on several new initiatives this year, we will be continuing to focus on curricular changes and engage with new standards. We believe these efforts will further enrich the learning experience and empower our students to achieve their fullest potential.

We are also delighted to share with you the progress we have made on the design of the new high school this summer. The construction documents are nearing completion, and we are preparing to present our work, along with updated geotechnical reports, to the Leet Township Planning Commission. We are steadfast about giving you accurate and timely information as we prepare to put the project out to bid this winter and commence construction this spring. This endeavor will undoubtedly enhance our community and provide state-of-the-art facilities for our students. IT IS TIME TO BUILD!

We understand the importance of keeping you informed, and that is why we will be hosting a community panel discussion about this important project on September 20th in the High School Auditorium at 6 p.m. We look forward to sharing our plans with our QV community, students, and staff. We are also hosting three additional tours of our property on Camp Meeting Road. On September 14th, we will host tours at 1 p.m. and 6 p.m. There will also be a tour hosted at 6 p.m. on October 5th.

Leading up to these exciting events, we have included new information about the project and additional renderings of the beautiful new spaces to come in this brochure.

We would like to extend our heartfelt gratitude to each and every one of you for your unwavering support. Together, we create an environment where education thrives and students flourish. Your commitment to the success of our district is truly appreciated. We are confident that this year will be filled with accomplishments, growth, and memorable moments. Quaker Valley is shining!

As the Superintendent and Board President of this great school district, it is our honor to be part of a community where students arrive with a readiness to learn and parents and educators work in partnership, demonstrating unwavering dedication and boundless energy to ensure our students' success.

It is going to be a great year, Quakers!

Warm regards,

Tammy A. Andreyko, Ed.D.
Superintendent of Schools

Jon Kuzma
School Board President

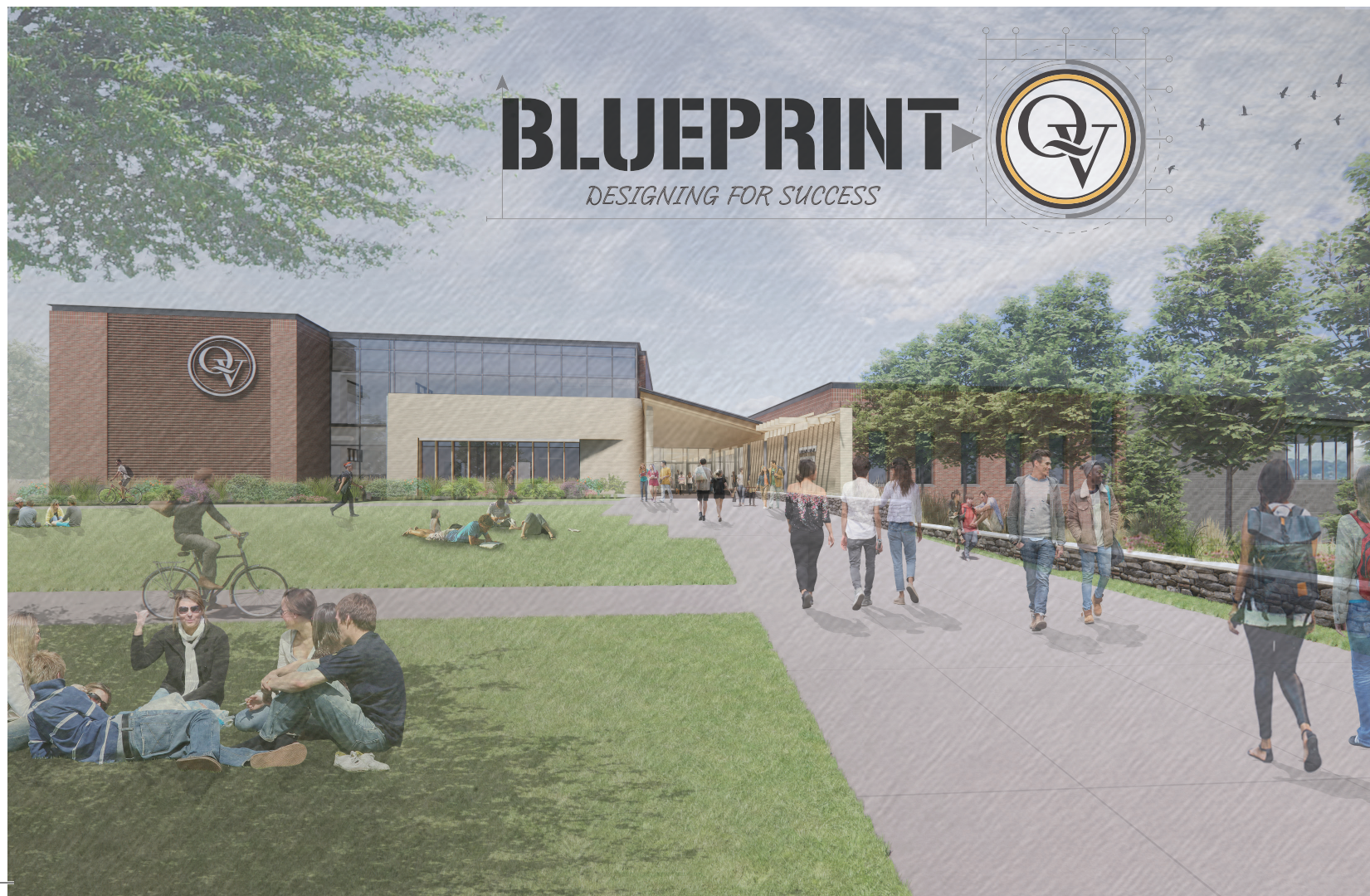

What will the **New QV High School** offer our students and community?



PEDESTRIAN AREAS

Pedestrian Areas Throughout the Campus Separated from Vehicular Traffic

In the current high school, pedestrian, bicycle, and vehicular traffic utilize the same paths with little to no separation. The site plan of the new high school carefully considers the safety of students, staff, and families as they approach the building, parking lots, bus drop-offs, and athletic facilities regardless of their mode of transportation.

The District also intends to provide pedestrian and bicycle paths, linking Beaver Street to the lower entrance.



PUBLIC SPACES

Cafeteria and Public Spaces

The gymnasium, auditorium, and cafeteria will be located on the lower level of the building, creating a space for athletic events, student performances, meetings, and more. A separate entrance will be utilized for after-hours events, allowing greater accessibility and limiting access to the academic wing of the building.

Separating the “public” spaces from the academic wing also allows our staff and families to know where students will be during after-school activities.

Improved Parking Availability and Accessibility for All

The new high school’s site plan increases parking availability from 200 spots at our current site to approximately 500 spots at the new site. It will ensure that attendees can find a spot and participate in our events without worrying about the inconvenience of limited space and lack of accessibility.

In addition to increased space, the new high school will be fully compliant with the Americans with Disabilities Act (ADA). This means that individuals with disabilities will have equal access to our facilities, including ramps, accessible parking spaces, accessible building entrances, and other necessary accommodations.



IMPROVED PARKING

Large and Small Group Instruction

The building also includes several large-group and small-group instructional spaces. Large-group instructional spaces allow teachers to combine classes for collaborative lessons, clubs to hold meetings in spaces conducive to their group size, and relieves pressure from the library to be one of the only spaces for groups to host events. There is a large-group space on each floor of the building.

Small-group spaces adjacent to the large-group spaces provide an opportunity for student groups to come together to study, work on projects, or hold meetings.



LARGE AND SMALL GROUP



SAFETY AND ACCESS

Site Safety and Building Access

The District wants everyone to be able to access our building for events and activities. The safety and security of our students, teachers, and staff is at the forefront of this planning. The campus has two entrances that create a loop around the building. During school hours, that loop will be closed to the public using controlled access gates.

Visitors to campus must enter through the front of the building, where the main office is located. They will buzz into a captured vestibule where they must sign in with office staff. Conference rooms and meeting spaces will be created adjacent to the main entrance, limiting visitors’ access, and preventing their traveling through the building to meeting spaces.



OUTDOOR SPACES

Outdoor Learning / Gathering Spaces

Outside the Library Media Center will be a courtyard available for students to collaborate and study or for teachers to hold outdoor lessons. An additional courtyard will be available outside the cafeteria. These two secure courtyards will be utilized during the school day and will not be accessible to visitors.

The campus includes additional greenspace, allowing teachers to take full advantage of outdoor learning opportunities within their curriculum.

Competition-Size Gymnasium and Improved Training Facilities

The current gymnasium only seats about 500 spectators. This is less than the total number of students in the current high school! The gymnasium at the new high school will be “competition-sized,” meaning it will be able to accommodate nearly 1,100 spectators and two simultaneous basketball courts or volleyball courts for games or practices.

One of the biggest drawbacks of our current gym is the lack of air conditioning. The lack of a suitable HVAC puts a strain on our students and athletes and limits their ability to practice and compete effectively. Our students and athletes deserve a top-notch facility to hone their skills, and everyone deserves a comfortable and safe environment to pursue their fitness goals.



COMPETITION-SIZE GYM

Engineering and Art Classrooms

Improved engineering, technology, and art spaces allow collaboration between classes and are designed with functionality in mind. Shared spaces such as the maker lab allow many groups to access the materials and equipment available for instruction.

These newly designed spaces will have large garage doors that provide access to the outdoors and the ability to move large projects throughout the campus including to and from the design and fabrication shop near the auditorium.



COLLABORATIVE SPACES



www.qvssd.org/BlueprintQV