

When R. A. Lutz Elementary opens its doors on January 8, 2024, a new era of public education will officially begin for the Baldwin-Whitehall School District including some changes in the locations of grade-level learning as well as investments and improvements in each one of our school building communities. Please review the BWSD Redistricting Plan for grade level building assignments, and learn more about our plans to ensure the best use of all five of our school buildings.



WHAT IS REDISTRICTING?

In public education, "redistricting" means changing the arrangement of which grade levels are taught in which District buildings. Some grades will not be affected, while others will begin reporting to their new buildings when the 2023-24 school year starts on August 28, 2023.



KEY POINTS & FUTURE BENEFITS

Opening R.A. Lutz Elementary in January 2024 rather than August 2023 is necessary due to delays that will prevent the new building from having its HVAC system installed before August.

Baldwin Middle School will continue to learn on-site at Baldwin High School, which will help optimize our transportation routes by minimizing the number of buses and drop-offs needed.

In January 2024, J.E. Harrison Education Center will experience a temporary, but significant, reduction in enrollment which will create an ideal opportunity to begin planned renovations. This will pave the way for welcoming the full future enrollment of all students in grades 6-8 in Fall 2024.

WHY ARE WE REDISTRICTING?

Since 2020, the BWSD Administration and School Board of Directors have evaluated nearly a dozen redistricting plans to carefully evaluate the best possible use of District resources and ideal learning environments for our students. Our current redistricting plans help us optimize our resources in some of the following ways:



Making better use of available learning space

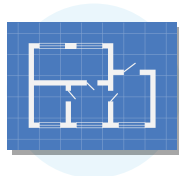

Creating renovation opportunities in Legacy School Buildings



Simplifying transportation routes for faster service







Maximizing the impact of all school funding

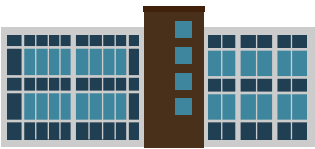

WHO IS AFFECTED AND WHERE WILL EACH GRADE REPORT?

Our chosen redistricting plan will only affect certain grades, who will change their learning locations on January 8, 2024, when winter break ends.

Baldwin High School		J. E. Harrison Education Center		R. A. Lutz Elementary School		Whitehall Elementary School	McAnnulty Elementary School
							
Grades 9-12	Grades 7-8	Grade 6	Grades 3-5	Grades 3-5	Grades 1-2	Grade K	
	will remain at Baldwin Middle School at BHS for 2023-24 School Year	will remain at J.E. Harrison Education Center for 1st Semester only (Through December 2023)	will remain at J.E. Harrison Education Center for 1st Semester only (Through December 2023)	will move to R. A. Lutz Elementary School for 2nd semester (Beginning January 4, 2024)			

All Students in **Grades 6-8** will report to J.E. Harrison Education Center in the 2024-25 School Year.

For more information on our 2023-24 redistricting plan, please visit www.bwschools.net/buildingourfuture.